

» CHECK LIST

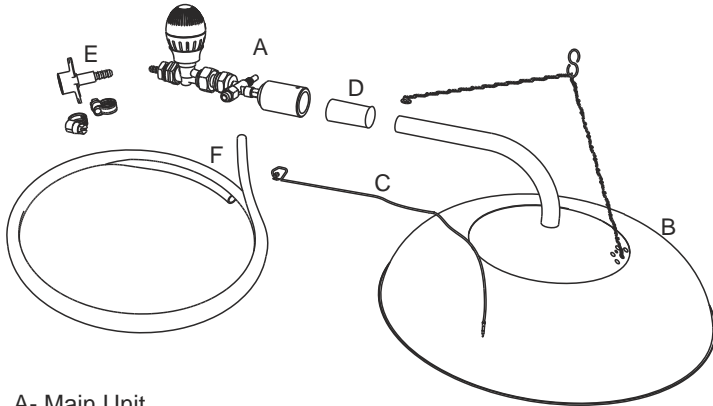

- A- Main Unit
- B- Canopy and Burner set
- C- Thermocouple
- D- Venturi
- Accessories - not included
- E- Gas conexión
- F- Hose

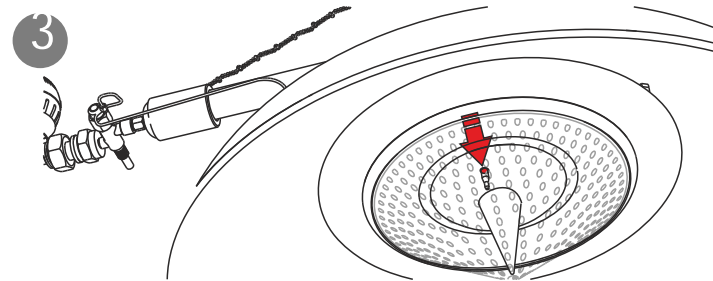

3 - Adjust the Thermocouple position of the using the Nut (17)

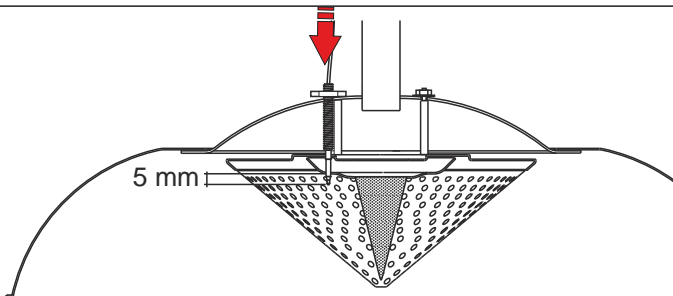

It must get in only 5 mm into the Outer Cone (15)

a ASSEMBLY INSTRUCTIONS

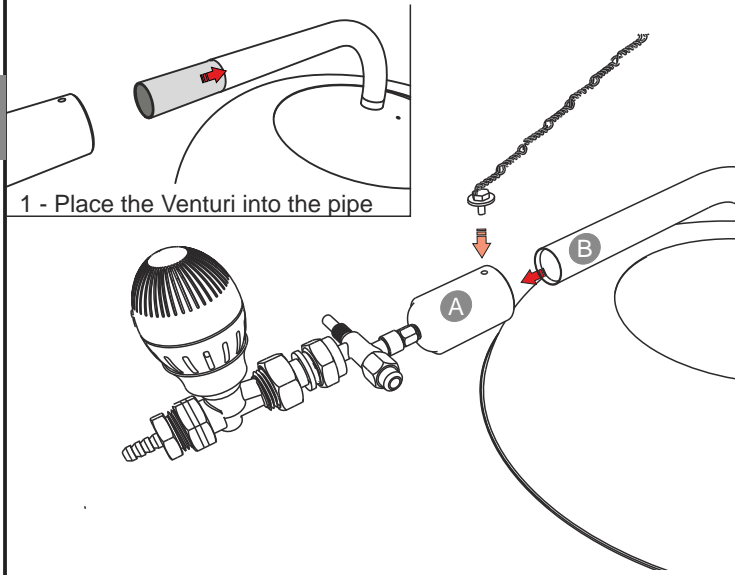

1 - Place the Venturi into the pipe

- 1 - Connect the Main unit (A) to the Canopy and Burner set(B)
- 2- Hold the chain with the screw and fasten the main unit

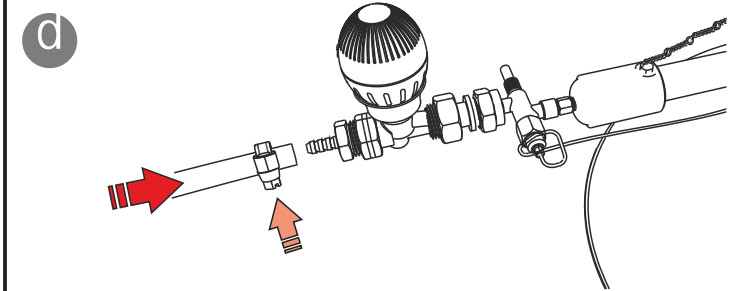

6- Connect the gas hose into the hose nipple fitting (1) and tight with the torque hose clamp

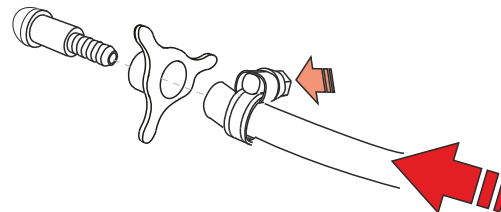

7- Connect the bronze hose nipple at the end of the gas hose. Tight with the torque hose clamp

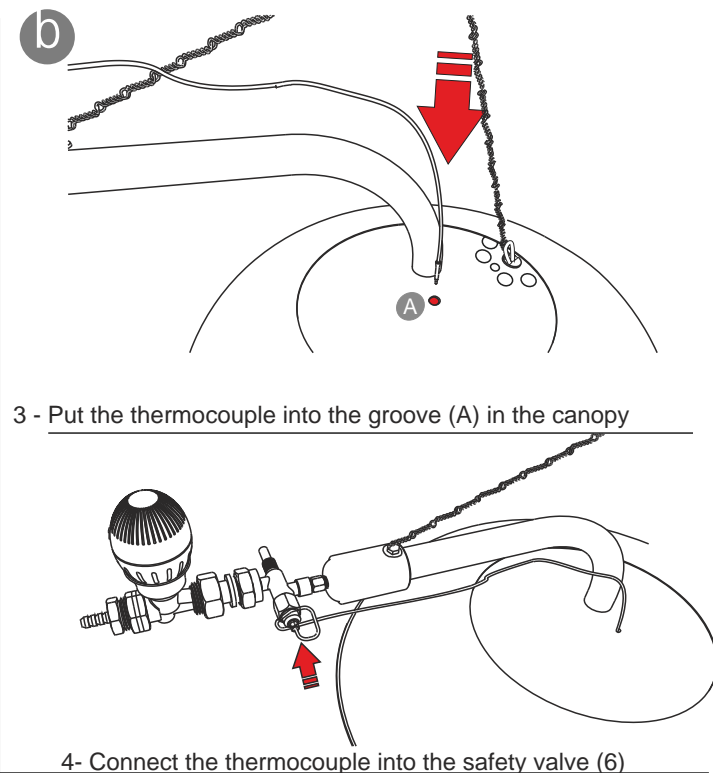

3 - Put the thermocouple into the groove (A) in the canopy

4- Connect the thermocouple into the safety valve (6)

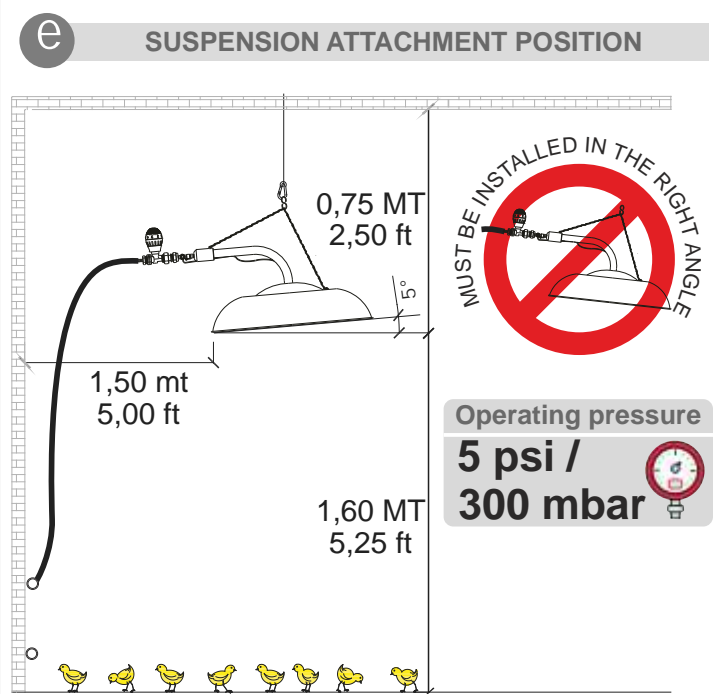

MINIMUM SAFETY DISTANCES

» GENERAL HAZARD WARNING

-Read this manual carefully and save it for futures references.

-The installation must be done by a qualified installer and accordingly with local regulations.

-Bourlot radiant brooders were designed for poultry applications. They must not be used for domestic applications.

-They must be used in well ventilated spaces.

-Make sure that the stopcock is closed before cleaning or removing the brooder.

-If you perceive gas odor or any gas loss, close the main line quickly.

FIRE AND EXPLOSION HAZARD

The improper use, manipulation and/or modification of the brooder or any part of it, may cause fire or explosion.



WARNING: HIGH VOLTAGE

Radiant brooders with spark ignition must be disconnected from the electrical supply before any maintenance.



ATTENTION

Bourlot Radiant Brooders are designed to work at a maximum of 1950 ft above sea level. Please contact our technical service to use it at a higher level.



ATTENTION

Please, respect the specific minimum clearance of each model.



» IGNITION INSTRUCTIONS

1. Check the gas supply pressure with a manometer. 300 bar/4.5 PSI is the right pressure.
2. Turn the thermostatic head to the maximum (Fig 1). In brooders with zone control, the thermostatic head is in the control panel.

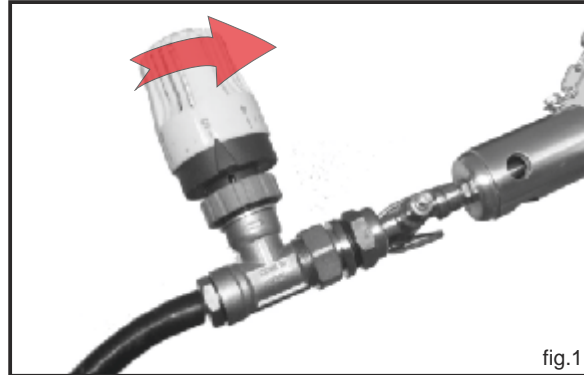

fig.1

3. Open the gas supply stopcock.
4. Hold down the button of the safety valve.
5. Apply flame in the second burner (fig 2).

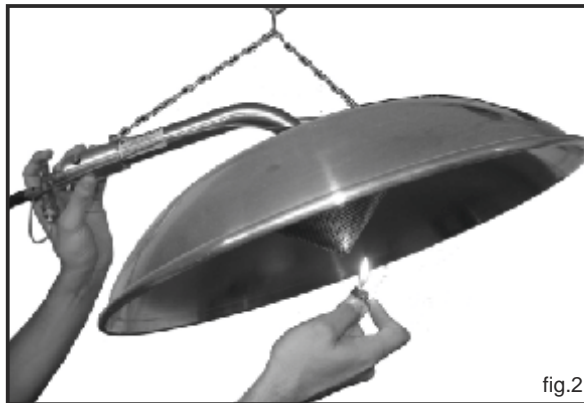

fig.2

6. After 15 seconds release the button of the safety valve.
7. Set the thermostatic head at the desired temperature.
8. In case the heater turn off, repeat all the steps again. In new installations is normal to be air trapped in the gas line. To purge the air trapped it is necessary to maintain pressing the safety valves button until the brooder remains lit.

» PERIODIC CLEANING

This kind of cleaning must be done on a weekly basis or more frequently, depending on enviromental conditions. This is important to maintain the proper performance and avoid future problems. To do it correctly, follow these steps:

1. Close the stopcock and unhang the brooder
2. Use compressed air. Place the hose (air blow gun) in the brooder air inlet and direct the air to the second burner (outer cone/outer burner).



fig.3

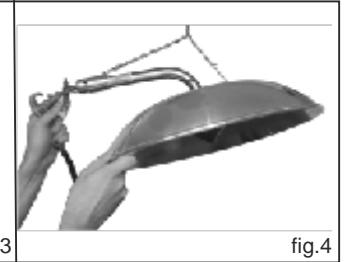

fig.4

3. Then, direct the air in the opposite direction, from the second burner to the air inlet. This time, the brooder must be on a vertical position, with the pipe downwards in order to facilitate the dust way out. 4. Repeat the process two or three times, until there is no more dirt or dust.

» MAINTENANCE

We recommend doing a deep cleaning with water at the end of each flock. To do it correctly, follow these steps:



ATTENTION

Do not clean the heater with high pressure washers!

1. Close the stopcock and wait until the brooder be cool.
2. Unhang the brooder
3. Remove the main unit (until the gasifier) and disconnect the thermocouple.
4. Take out the venturi tube from the steel pipe.
5. Apply water with a little pressure, placing the hose in the steel pipe directing the water towards the main burner. Then, apply it in the opposite direction placing the hose in the burner. This time, the brooder must be on a vertical position, with the pipe downwards in order to facilitate the dust way out. In case of greasy dirt, clean the brooder with water and a bit of detergent.
6. Repeat the steps (5) until water runs clean.
7. Wait until the brooder has dried completely to use it again.

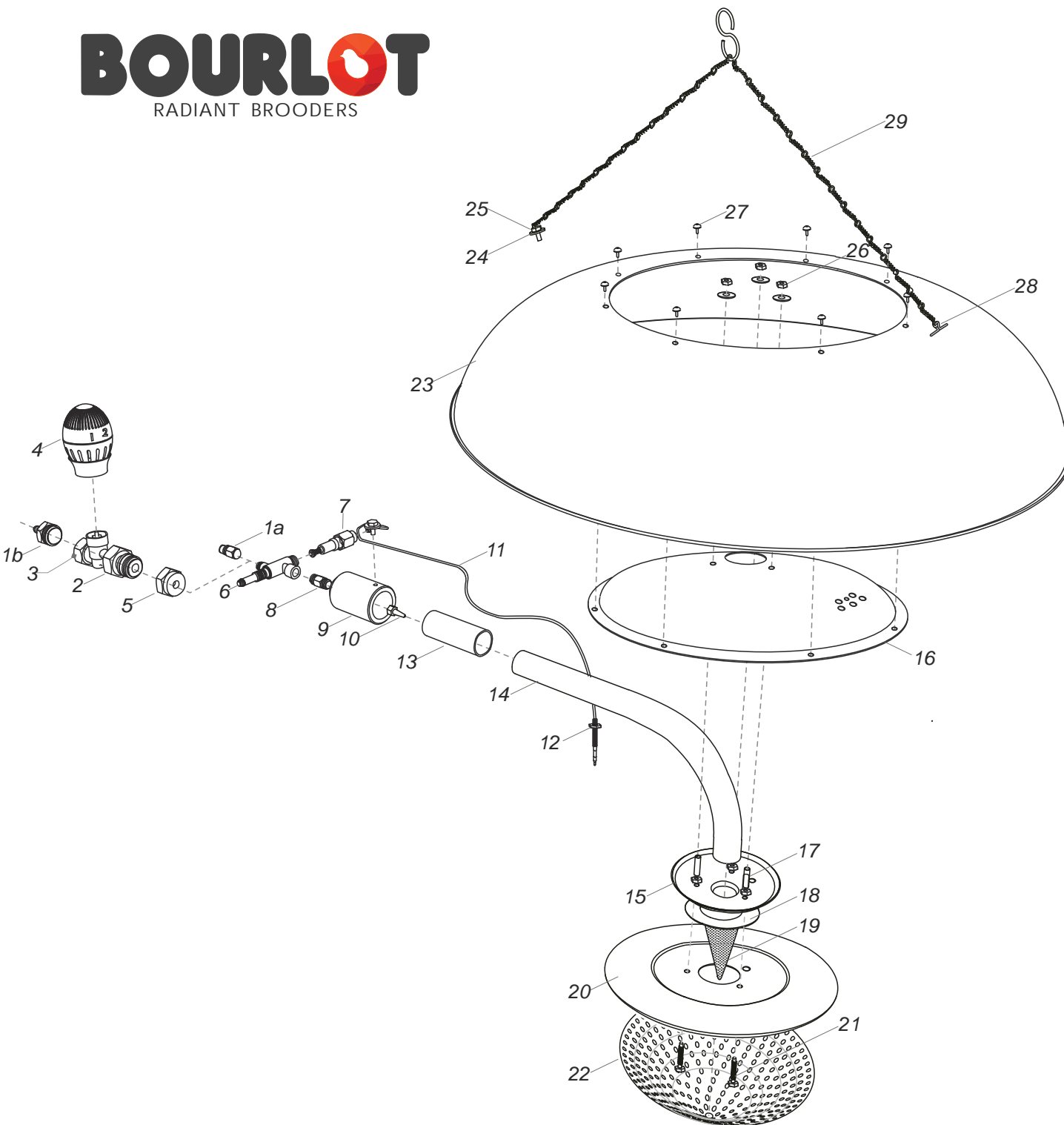

► PARTS LIST

NR	Art	Description
1a	100257	Hose nipple fitting 1/8" x 5/16"
1b	100047	Hose nipple fitting 1/2" x 5/16"
2	100050	Modulating valve
3	100073	Injector Pilot
4	100051	Thermostatic head
5	100208	Nut 1/2" X 1/8" BSP
6	100048	Safety valve
7	100233	Thermal fuse
8	100632	Nipple MM 1/8" X 1/8"
9	100604	Air housing - Air inlet combustion
10	100613	Main Injector
11	100056	Thermocouple
12	100072	Thermocouple nut 7/16"
13	100054	Venturi nozzle
14	100057	Pipe SS 28.6
15	100504	Flange SS
16	100061	Top Plate Al
17	100112	Spacers Al
18	100064	Gasket
19	100065	Inner Cone GP
20	100059	Burner Plate GP
21	100538	Screw SS 5x40 mm
22	100066	Outer Cone GP
23	100063	Aluminium Canopy GP
24	100070	Washer 3/16"
25	100536	Screw SS 5x10 mm
26	100673	Nut SS 5x0.8mm
27	100652	Pop Rivet 4,8x8mm
28	100071	Cotter SS 3x30mm
29	100032	Suspension chain